

LEWISTON FINANCE COMMITTEE MEETING

Agenda

Finance Committee meeting, **Monday**, May 6, 2013 at **5:15** p.m. in the **Administrative Conference Room**, Lewiston City Hall.

1. Call meeting to.
2. Review minutes of previous meeting dated April 22, 2013.
3. Recommendation from the Purchasing Director regarding award of Bid 2013-020 on the Bartlett Street Water and Sewer Replacement Project.
4. Recommendation from the Purchasing Director regarding award of Bid 2013-015 on the Jepson Brook Sewer Separation Phase III Project.
5. Recommendation from the Purchasing Director regarding award of Bid 2013-019 on the Jepson Brook Sewer Separation Phase IV Project.
6. Recommendation from the Purchasing Director regarding Task Order with Gorrill-Palmer for Construction Inspection on Jepson Brook Phase III and Phase IV.
7. Recommendation from the Purchasing Director regarding award of Bid 2013-021 for Tax Bill Outsourcing and Bid 2013-022 for Water, Sewer and Storm Water Bill Outsourcing.
8. Recommendation from the Purchasing Director regarding award of Bid 2013-023 for Work Zone Traffic Control (Flaggers).
9. Other Business
10. Adjourn

FINANCE COMMITTEE LEWISTON, MAINE

**Minutes of
April 22, 2013**

PRESENT: Michael Marcotte, Robert Reed, Stavros Mendros, Councilor Mark Cayer and Councilor Doreen Christ.

OTHERS PRESENT: Public Works Director David Jones, Electrical Operations Manager Denis Caron and Director of Budget/ Purchasing Norman Beauparlant.

Meeting was called to order at 5:15 p.m. by Chairman Mendros.

On motion of Mr. Marcotte, seconded by Councilor Cayer it was

VOTED:

(022-2013) To approve the minutes of the previous meeting dated March 18, 2013 and to accept and place them on file as presented by the Clerk.

VOTE: 5-0

At this time, the Purchasing Director presented an overview of Bid 2013-009 for Public Works Uniform Rentals tabled at the March 18, 2013 meeting.

On recommendation of the Purchasing Director and on motion of Councilor Cayer, seconded by Councilor Christ it was

VOTED:

(023-2013) To award of Bid 2013-009 for Public Works Uniform Rentals to Unifirst Corporation, Portland, Maine, for a three (3) year term at their fixed pricing for all items listed.

VOTE: 5-0

On recommendation of the Purchasing Director and on motion of Mr. Reed, seconded by Councilor Cayer it was

VOTED:

(024-2013) To award Bid 2013-013 for three (3) MTE Harmonic Filters to be installed at the Main Street Pump Station to Stultz Electric, Portland, Maine, sole bidder at their bid price of \$32,964, with installation to be done by City Electrical Division.

VOTE: 5-0

FINANCE COMMITTEE MINUTES**April 22, 2013**

On recommendation of the Purchasing Director and on motion of Mr. Reed, seconded by Councilor Cayer it was

VOTED:

(025-2013) To award Bid 2013-008 for Custodial Services at various municipal buildings with locations as follows:

Facility	Contractor	Year 1	Year 2	Year 3
Violations Bureau	Pegasus Cleaning	\$9,620.00	\$9,620.00	\$9,620.00
Police Facility	Pegasus Cleaning	19,500.00	19,500.00	19,500.00
City Hall*	Capital Contractors	23,086.56	23,086.56	23,213.52
Library	Pathways	29,982.00	30,826.00	31,751.00
Public Works/Water/Sewer	Capital Contractors	16,201.28	16,211.28	16,441.28
Solid Waster	Capital Contractors	3,224.00	3,224.00	3,224.00

Contract term is 7/1/2013 – 7/1/2015 with an option to extend for an additional year at fixed prices stated.

VOTE: 5-0

At this time, the Purchasing Director presented an overview of Bid 2013-003 on the Oak Street Sewer Separation Phase IV Project.

Mr. Marcotte made a motion to award the bid to Gendron & Gendron, Lewiston, third low bidder on the basis that he felt Gendron & Gendron best understood the work needed. Motion failed for lack of a second.

On recommendation of the Purchasing Director and on motion of Councilor Cayer, seconded by Mr. Reed it was

VOTED:

(026-2013) To award of Bid 2013-003 on the Oak Street Sewer Separation Phase IV Project to St. Laurent & Son, Lewiston, low bidder at their base bid price of \$1,279,259 based on estimated quantities. It is further understood that if funding is provided by the City Council, the alternate work would be added by Change Order in the amount of \$218,642.

VOTE: 5-0

On recommendation of the Purchasing Director and on motion of Mr. Marcotte, seconded by Councilor Christ it was

VOTED:

(027-2013) To authorize Task Order with Gorrill-Palmer Consulting Engineers Inc. for construction inspection services on the Oak Street Phase IV project at an estimated cost of \$87,590.

VOTE: 5-0

FINANCE COMMITTEE MINUTES

April 22, 2013

On recommendation of the Purchasing Director and on motion of Councilor Cayer, seconded by Mr. Reed it was

VOTED:

(028-2013) To award of Bid 2013-016 for Bituminous Pavement picked up at vendor’s plant on an item by item basis as follows:

Item 1	Type 19 mm	White Brothers	\$65.70
Item 2	Type 12.5 mm	White Brothers	68.70
Item 3	Type 9.5 mm	Auburn Asphalt	68.00
Item 4	Curb Mix	Auburn Asphalt	90.00

VOTE: 5-0

On recommendation of the Purchasing Director and on motion of Mr. Reed, seconded by Councilor Christ it was

VOTED:

(029-2013) To award Bid LA 2013-001 for Utility Trench Restoration to T W Paving, low bidder overall taking into consideration all methods at it unit prices as follows:

Method A	\$28.00/SY
Method B	30.00/SY
Method C	35.00/SY
Method D	36.00/SY

VOTE: 5-0

On recommendation of the Purchasing Director and on motion of Councilor Cayer, seconded by Mr. Reed it was

VOTED: (030-2013) To award of Bid 2013-010 on the Mill Street Storm Drain and Sidewalk Project to Longchamps & Sons, Lisbon, Maine, low bidder for the Base Bid only in the amount of \$74,111.50.

VOTE: 4-0-1

Mr. Marcotte opposed

At this time, the Purchasing Director advised the Committee of the purchase of benches and waste receptacles that had been purchased from two (2) separate vendors on April 1, 2013 on the basis of sole source for benches because the benches were ordered to match benches already in place along Lincoln Street and that the waste receptacles were bid last year and selected to be the same for the two projects.

Committee members were concerned that the Purchasing Director had not brought a request for Waiver to them prior to ordering the units however, the Committee understood that no action was needed by the Committee.

FINANCE COMMITTEE MINUTES

April 22, 2013

At this time, the Purchasing Director opened discussion with the Finance Committee about making a recommendation to the City Council with regard to the FY 2014 Budget. In providing background, Mr. Marcotte had requested that the prior two years Finance Committee recommendations to City Council be provided to the Committee as part of the Agenda package issued on Friday, April 19, 2013. Mr. Marcotte and Mr. Reed each brought suggestions for Committee members to consider.

After discussion by the Committee and on motion of Councilor Cayer, seconded by Councilor Christ it was

VOTED:

(031-2013) After careful review of the Lewiston City Administrator FY2014 proposed budget, the Finance Committee feels it most important to first remind our City officials that federal spending followed by sequestration added to the State's inability to control its spending habits is now more than ever resulting in towns and cities feeling a heavier burden than one should expect. Given the largest share of those local revenues are now based on property taxes, our homeowners are faced with higher State and Federal income taxes as well as increased property taxes locally.

Lewiston suffers from an aging housing stock, abandoned businesses and recently even more single family residences foreclosed on - unpaid debts typically include unpaid escrow for property taxes and insurance. While City officials may have a vision to create a more livable City, that vision will not be possible until we control our spending habits and unsustainable continued level of debt service. Each year the Finance Committee provides this warning to the Mayor, City Council and Administrator, only to have the document forgotten once the start of the new fiscal year begins.

An aging housing stock coupled with increasing taxes due to increased debt service and continued spending will not be positive signs to attract the new permanent residents we might wish to attract in order to make the vision a reality. While an argument might be made that "if you build it they will come", you also run the significant risk of losing those current residents who can no longer afford the vision or cannot carry the load in hopes of others joining later.

Lastly, we offer two recommendations to the elected officials of this City. First you must have the foresight to reduce that tax burden and look at all options for doing business including outsourcing, shared services with other communities and combined departments and divisions. It may even be time to consider a merger of services with other communities. Secondly, you must hold elected and appointed officials at all levels of government to the same standard. Gone are the days when economic development was a sure thing. We must account for every dollar spent and every dollar collected at all levels of government. We have a spending problem at all levels of government and until our elected leaders can recognize and take steps to change that habit, the cost will fall more than ever upon the homeowners of this City.

VOTE: 5-0

VOTED:

To adjourn at 6:35 p.m.

Norman Beuparlant
Clerk
Finance Committee



Finance Committee

Norman J. Beuparlant
Director of Budget/Purchasing
nbeuparlant@lewistonmaine.gov



Item # 3

to: Finance Committee
from: Norman Beuparlant, Purchasing Director
subject: Bid 2013-020 Bartlett Street Water and Sewer Replacement
date: May 6, 2013

It is recommended that Bid 2013-020 for water and sewer line replacement be awarded to Gendron & Gendron, Lewiston, Maine, low bidder at their bid price of \$361,626.35.

Note: Project area shown on attached plan sheet. Bartlett Street from Adams Avenue to Birch Street and Bartlett Street from Ash Street to Sabattus Street.

NJB/syt



Department of Public Works

David A. Jones, P.E.
Director



TO: Norman Beauparlant
FROM: Jeff Beaulé, Project Engineer
DATE: 5/3/13

SUBJECT: Bartlett St Water and Sewer Replacement Award Recommendation

The Engineering Division recommends award of the above project, Bid No. 2013-020, to the apparent low bidder Gendron and Gendron, Inc. in the amount of \$361,626.35.

Gendron and Gendron has successfully completed similar projects for the City of Lewiston and the bid price is well below the project budget, as shown below:

Part 1: Water Main Replacement

Budgeted amount in 2013 Distribution Main Replacement for construction: \$280,000.00

Part 1 construction BID: \$199,783.15

Part 2: Sewer Main Replacement

Budgeted amount in 2013 Sanitary Main Rehab account: \$325,000.00

Part 2 construction BID: \$161,843.20

AN EQUAL OPPORTUNITY EMPLOYER

The City of Lewiston is an EOE. For more information, please visit our website @ www.lewistonmaine.gov and click on the Non-Discrimination Policy.

Department of Public Works • 103 Adams Ave • Lewiston, ME • 04240 • Voice Tel. 207-513-3003 • Fax 207-784-5647 • TTY/TDD 207-513-3007 – www.lewistonmaine.gov

Bartlett Street Water & Sewer Replacement

Bid #: 2013-020															
Gendron & Gendron				Longchamps & Sons				St. Laurent & Son		McGee Construction		Pratt & Sons		C H Stevenson	
Lewiston ME				Lisbon ME				Lewiston ME		West Gardiner ME		Mechanic Falls ME		Wayne ME	
#	Qty	Unit	Description	Unit \$	Total \$	Unit \$	Total \$	Unit \$	Total \$	Unit \$	Total \$	Unit \$	Total \$	Unit \$	Total \$
Part 1: Water Main Replacement															
1	1,920	LF	Install 6-8" water main	29.00	\$ 55,680.00	25.00	48,000.00	29.00	55,680.00	29.00	55,680.00	26.00	49,920.00	33.50	64,320.00
2	2	EA	Install hydrant	750.00	1,500.00	1,200.00	2,400.00	1,600.00	3,200.00	800.00	1,600.00	2,100.00	4,200.00	2,250.00	4,500.00
3	21	EA	Install/reconnect 3/4" or 1" service	550.00	11,550.00	800.00	16,800.00	850.00	17,850.00	800.00	16,800.00	1,040.00	21,840.00	1,300.00	27,300.00
4	5	EA	reconnect exist. 3/4-2" srv to main	650.00	3,250.00	800.00	4,000.00	850.00	4,250.00	800.00	4,000.00	655.00	3,275.00	1,030.00	5,150.00
5	5	EA	test pits	15.00	75.00	100.00	500.00	400.00	2,000.00	250.00	1,250.00	180.00	900.00	430.00	2,150.00
6	15	CY	rock & boulder excavation	0.01	0.15	200.00	3,000.00	0.01	0.15	0.01	0.15	175.00	2,625.00	200.00	3,000.00
7	475	CY	Aggregate base	16.50	7,837.50	14.00	6,650.00	19.00	9,025.00	16.00	7,600.00	16.40	7,790.00	15.00	7,125.00
8	950	CY	Aggregate sub-base	16.00	15,200.00	11.00	10,450.00	18.00	17,100.00	14.00	13,300.00	15.30	14,535.00	14.00	13,300.00
9	200	CY	select backfill	13.80	2,760.00	10.00	2,000.00	9.00	1,800.00	10.00	2,000.00	14.50	2,900.00	12.00	2,400.00
10	430	TON	F/I 19mm HMA	82.25	35,367.50	82.25	35,367.50	85.00	36,550.00	92.00	39,560.00	85.25	36,657.50	87.00	37,410.00
11	215	TON	F/I 9.5mm HMA	93.70	20,145.50	93.70	20,145.50	95.00	20,425.00	103.00	22,145.00	96.70	20,790.50	95.50	20,532.50
12	100	TON	F/I 9.5mm HMA, hand placed	112.50	11,250.00	118.00	11,800.00	115.00	11,500.00	113.00	11,300.00	121.00	12,100.00	116.00	11,600.00
13	1	LS	Miscellaneous work	6,600.00	6,600.00	2,500.00	2,500.00	7,500.00	7,500.00	8,000.00	8,000.00	7,085.00	7,085.00	3,400.00	3,400.00
14	1	LS	Mobilization & Cleanup	3,900.00	3,900.00	10,000.00	10,000.00	8,000.00	8,000.00	8,000.00	8,000.00	15,000.00	15,000.00	16,000.00	16,000.00
15	50	SY	Loam & seed	7.80	390.00	4.00	200.00	5.00	250.00	5.00	250.00	5.00	250.00	12.00	600.00
16	2,850	SY	Prep trench & Sidewalk for paving	5.15	14,677.50	5.00	14,250.00	5.00	14,250.00	5.50	15,675.00	2.00	5,700.00	2.00	5,700.00
17	600	HR	Flagger	16.00	9,600.00	18.00	10,800.00	15.50	9,300.00	16.00	9,600.00	15.00	9,000.00	20.00	12,000.00
TOTAL PART 1: WATER MAIN REPLACE.				\$	199,783.15	\$	198,863.00	\$	218,680.15	\$	216,760.15	\$	214,568.00	\$	236,487.50
Bid #: 2013-020															
Gendron & Gendron				Longchamps & Sons				St. Laurent & Son		McGee Construction		Pratt & Sons		C H Stevenson	
Lewiston ME				Lisbon ME				Lewiston ME		West Gardiner ME		Mechanic Falls ME		Wayne ME	
#	Qty	Unit	Description	Unit \$	Total \$	Unit \$	Total \$	Unit \$	Total \$	Unit \$	Total \$	Unit \$	Total \$	Unit \$	Total \$
Part 2: Sewer Main Replacement															
1	180	LF	F/I 8" PVC sewer main	31.00	5,580.00	65.00	11,700.00	38.00	6,840.00	55.00	9,900.00	45.00	8,100.00	77.00	13,860.00
2	815	LF	F/I 15" sewer main	41.00	33,415.00	69.00	56,235.00	45.00	36,675.00	72.00	58,680.00	76.00	61,940.00	86.00	70,090.00
3	40	LF	F/I 8" catch basin lead	65.00	2,600.00	40.00	1,600.00	72.00	2,880.00	75.00	3,000.00	48.00	1,920.00	42.00	1,680.00
4	24	EA	Reconnect sewer service	700.00	16,800.00	350.00	8,400.00	250.00	6,000.00	720.00	17,280.00	440.00	10,560.00	675.00	16,200.00
5	5	EA	F/I 4' dia. Sewer manhole	2,925.00	14,625.00	3,400.00	17,000.00	4,000.00	20,000.00	4,000.00	20,000.00	4,100.00	20,500.00	3,400.00	17,000.00
6	5	EA	test pits	0.01	0.05	100.00	500.00	400.00	2,000.00	200.00	1,000.00	180.00	900.00	430.00	2,150.00
7	15	CY	rock & boulder excavation	0.01	0.15	100.00	1,500.00	200.00	3,000.00	0.01	0.15	175.00	2,625.00	200.00	3,000.00
8	250	CY	Aggregate base	16.50	4,125.00	14.00	3,500.00	19.00	4,750.00	16.00	4,000.00	16.40	4,100.00	15.00	3,750.00
9	500	CY	Aggregate sub-base	16.00	8,000.00	19.00	9,500.00	18.00	9,000.00	14.00	7,000.00	15.30	7,650.00	14.00	7,000.00
10	400	CY	select backfill	13.50	5,400.00	15.00	6,000.00	9.00	3,600.00	8.00	3,200.00	14.50	5,800.00	12.00	4,800.00
11	230	TON	F/I 19mm HMA	82.25	18,917.50	82.25	18,917.50	85.00	19,550.00	92.00	21,160.00	85.25	19,607.50	87.00	20,010.00
12	115	TON	F/I 9.5mm HMA	93.70	10,775.50	93.70	10,775.50	95.00	10,925.00	103.00	11,845.00	96.70	11,120.50	95.50	10,982.50
13	50	TON	F/I 9.5mm HMA, hand placed	112.50	5,625.00	118.00	5,900.00	115.00	5,750.00	113.00	5,650.00	121.00	6,050.00	116.00	5,800.00
14	1	LS	Miscellaneous work	15,900.00	15,900.00	5,000.00	5,000.00	5,553.00	5,553.00	8,000.00	8,000.00	10,433.00	10,433.00	5,700.00	5,700.00
15	1	LS	Mobilization & Cleanup	4,500.00	4,500.00	5,000.00	5,000.00	9,000.00	9,000.00	6,000.00	6,000.00	14,000.00	14,000.00	19,700.00	19,700.00
16	50	SY	Loam & seed	6.40	320.00	4.00	200.00	5.00	250.00	5.00	250.00	5.00	250.00	12.00	600.00
17	1,400	SY	Prep trench & Sidewalk for paving	5.15	7,210.00	5.00	7,000.00	5.00	7,000.00	5.00	7,000.00	2.00	2,800.00	2.00	2,800.00
18	200	HR	Flagger	16.00	3,200.00	18.00	3,600.00	15.50	3,100.00	15.00	3,000.00	15.00	3,000.00	20.00	4,000.00
19	50	SY	Disposal of special excavation	51.00	2,550.00	50.00	2,500.00	100.00	5,000.00	80.00	4,000.00	180.00	9,000.00	65.00	3,250.00
20	50	LF	Disposal of Asbestos pipe	46.00	2,300.00	30.00	1,500.00	0.01	0.50	50.00	2,500.00	24.00	1,200.00	115.00	5,750.00
TOTAL PART 2: SEWER MAIN REPLACE.				\$	161,843.20	\$	176,328.00	\$	160,873.50	\$	193,465.15	\$	201,556.00	\$	218,122.50
TOTAL PART 1 & 2				\$	361,626.35	\$	375,191.00	\$	379,553.65	\$	410,225.30	\$	416,124.00	\$	454,610.00

CITY OF LEWISTON



DEPARTMENT OF PUBLIC WORKS ENGINEERING DIVISION

103 ADAMS AVENUE
LEWISTON, MAINE 04240
TEL. (207) 513-3003
FAX (207) 784-5647

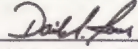
PUBLIC WORKS DIRECTOR

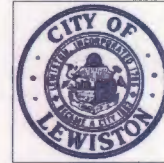
David A. Jones, P.E.
CITY ENGINEER





Richard C. Burnham, P.E.
PROJECT ENGINEER
Jeffrey D. Beaulé, P.E.

APRIL 2013



INDEX OF SHEETS

GENERAL NOTES	N-1
DETAILS	D-1
PLANS	P-1 TO P-3

BARTLETT STREET WATER AND SEWER REPLACEMENT

BID NO. 2013-020



14-181-13



Finance Committee

Norman J. Beuparlant
Director of Budget/Purchasing
nbeuparlant@lewistonmaine.gov



Item # 4

to: Finance Committee
from: Norman Beuparlant, Purchasing Director
subject: Bid 2013-015 Jepson Brook Sewer Separation Phase III
date: May 6, 2013

Bids were opened on May 2, 2013 for the work on Jepson Brook Phase III for work as shown on the project map.

The bids have been evaluated by the Public Works Department.

It is recommended that Bid 2013-015 be awarded to Gendron & Gendron, Lewiston, Maine, low bidder at their bid price of \$916,039 based on estimated quantities.

Note: The attached memo from the Project Engineer deals with three (3) items in one memo. I asked the engineer to provide the recommendation in this fashion to show the entire scope of work as budgeted.

NJB/syt



Department of Public Works

David A. Jones, PE
Director



DATE: May 2, 2013

TO: Norman Beauparlant, Director of Budget/Purchasing

FROM: Ryan Barnes, P.E., Project Engineer

SUBJECT: Jepson Brook CSO Phase III & Phase IV Projects

Bid 2013-015 and 2013-019

1. Recommend awarding the contract for **Jepson Brook Phase III** to Gendron & Gendron of Lewiston at their bid price of \$916,039.00. The project will be fully funded through the Jepson Brook Stormwater and Sewer accounts. A copy of the bid tabulation for the project is attached for your reference.
2. Recommend awarding the contract for **Jepson Brook Phase IV** to Longchamps & Sons of Lisbon at their bid price of \$597,335.00. The CSO separation portion of the project will be fully funded through the Jepson Brook Stormwater and Sewer accounts and the Water work will be fully funded through the 2013 water bond. A copy of the bid tabulation for the project is attached for your reference.
3. Recommend awarding the task order for the **Construction Phase Services for Jepson Brook Phase III & IV** to Gorrill Palmer Consulting Engineers of Gray at their proposal price of \$88,750.00. The project will be fully funded through the Jepson Brook Stormwater and Sewer accounts. A copy of the proposal for the project is attached for your reference.

A complete breakdown of the funding for the above referenced projects is shown below:

Account Summary – Jepson Brook

642 6422202 – Jepson Brook Stormwater 2012	\$ 325,300.00
622 6222202 – Jepson Brook Sewer 2012	\$ 268,880.00
643 6433404 – Jepson Brook Stormwater 2013	\$ 1,000,000.00
623 6233404 – Jepson Brook Sewer 2013	\$ 1,000,000.00
Account Balance	\$ 2,594,180.00
Phase III – Construction (Contractor)	\$ 916,039.00
Phase IV – Construction – Longchamps & Sons	\$ 480,757.75
Construction Inspection – Gorrill-Palmer	\$ 88,750.00
Balance	\$ 1,108,633.25

Account Summary – Little/Googin Water

Account Balance	\$ 229,775.00
Little Googin Water – Longchamps & Sons	\$ 116,577.25
Balance	\$ 113,197.75

Jepson Brook Sewer Separation Phase III

Bid #: 2013-015				Longchamps & Sons		Gendron & Gendron		McGee Construction		St. Laurent & Son	
				Lisbon ME		Lewiston ME		West Gardiner ME		Lewiston ME	
#	Qty	Unit	Description	Unit \$	Total \$	Unit \$	Total \$	Unit \$	Total \$	Unit \$	Total \$
1	2	EA	remove manhole or catch basin	500.00	1,000.00	500.00	1,000.00	500.00	1,000.00	420.00	840.00
2	100	CY	Granular borrow	12.00	1,200.00	15.50	1,550.00	10.00	1,000.00	20.00	2,000.00
3	400	CY	crushed stone	25.00	10,000.00	18.40	7,360.00	18.00	7,200.00	24.00	9,600.00
4	20	EA	test pit excavation	500.00	10,000.00	75.00	1,500.00	300.00	6,000.00	205.00	4,100.00
5	100	CY	structural earth ex. Drainage etc.	40.00	4,000.00	17.75	1,775.00	10.00	1,000.00	15.00	1,500.00
6	1,000	CY	structural rock excavation	117.00	117,000.00	184.00	184,000.00	150.00	150,000.00	200.00	200,000.00
7	500	CY	aggregate base crushed	19.00	9,500.00	15.50	7,750.00	20.00	10,000.00	19.00	9,500.00
8	2,100	CY	aggregate sub-base gravel	18.00	37,800.00	16.50	34,650.00	16.00	33,600.00	17.00	35,700.00
9	5,000	SY	fine grade/prep areas for paving	5.00	25,000.00	5.50	27,500.00	6.00	30,000.00	5.50	27,500.00
10	600	TON	HMA 19.0 mm	83.00	49,800.00	82.11	49,266.00	90.00	54,000.00	84.00	50,400.00
11	220	TON	HMA 9.5 mm	93.00	20,460.00	92.80	20,416.00	95.00	20,900.00	97.00	21,340.00
12	210	TON	HMA 12.5 mm	84.00	17,640.00	83.12	17,455.20	130.00	27,300.00	83.00	17,430.00
13	150	TON	HMA hand placed	116.00	17,400.00	115.00	17,250.00	140.00	21,000.00	115.00	17,250.00
14	320	LF	8" PVC sewer main	50.00	16,000.00	34.00	10,880.00	60.00	19,200.00	61.00	19,520.00
15	380	LF	15" PVC sewer main	70.00	26,600.00	52.00	19,760.00	60.00	22,800.00	61.00	23,180.00
16	1	LS	by pass dumping/sewage flow contr.	10,000.00	10,000.00	2,500.00	2,500.00	10,000.00	10,000.00	10,000.00	10,000.00
17	1	LS	abandonment of sewers	8,000.00	8,000.00	1,000.00	1,000.00	5,000.00	5,000.00	9,000.00	9,000.00
18	3	EA	4' dia. Sanitary manhole	4,000.00	12,000.00	2,600.00	7,800.00	4,000.00	12,000.00	3,500.00	10,500.00
19	500	LF	replace exist. 4,6&8" sanit. House lat.	50.00	25,000.00	47.00	23,500.00	50.00	25,000.00	58.00	29,000.00
20	100	LF	relocate existing sewer service	45.00	4,500.00	78.00	7,800.00	50.00	5,000.00	87.00	8,700.00
21	60	LF	6" dis. PVC storm drain	35.00	2,100.00	38.00	2,280.00	40.00	2,400.00	45.00	2,700.00
22	10	LF	8" dia. HDPE storm drain	50.00	500.00	42.00	420.00	45.00	450.00	70.00	700.00
23	760	LF	12" dis. Sanitite storm drain	42.00	31,920.00	36.00	27,360.00	50.00	38,000.00	51.50	39,140.00
24	375	LF	15" dia. Sanitite storm drain	60.00	22,500.00	43.00	16,125.00	60.00	22,500.00	55.00	20,625.00
25	40	LF	18" dia. Sanitite storm drain	100.00	4,000.00	58.00	2,320.00	70.00	2,800.00	63.00	2,520.00
26	70	LF	24" dia. Sanitite storm drain	130.00	9,100.00	67.00	4,690.00	72.00	5,040.00	80.00	5,600.00
27	380	LF	30" dia. Sanitite storm drain	130.00	49,400.00	58.00	22,040.00	100.00	38,000.00	101.00	38,380.00
28	1,575	LF	36" dia. Sanitite storm drain	202.00	318,150.00	77.00	121,275.00	110.00	173,250.00	125.00	196,875.00
29	75	LF	36" dia. ADS-12 storm drain	187.00	14,025.00	56.00	4,200.00	100.00	7,500.00	121.00	9,075.00
30	20	EA	4' dia. Catch basin	3,200.00	64,000.00	2,240.00	44,800.00	4,400.00	88,000.00	2,670.00	53,400.00
31	4	EA	5' dia. Catch basin	4,000.00	16,000.00	2,675.00	10,700.00	5,000.00	20,000.00	3,500.00	14,000.00
32	7	EA	4' dia. Manhole	3,600.00	25,200.00	2,550.00	17,850.00	6,000.00	42,000.00	2,500.00	17,500.00
33	7	EA	5' dia. Manhole	8,000.00	56,000.00	2,980.00	20,860.00	7,000.00	49,000.00	3,425.00	23,975.00
34	3	EA	6' dia. Manhole	12,000.00	36,000.00	4,220.00	12,660.00	9,000.00	27,000.00	4,525.00	13,575.00
35	6	EA	alter catch basin or manhole	1,000.00	6,000.00	700.00	4,200.00	1,000.00	6,000.00	500.00	3,000.00
36	520	LF	install 6" DI Water main	35.00	18,200.00	22.00	11,440.00	28.00	14,560.00	34.00	17,680.00
37	170	LF	install 8" DI Water main	35.00	5,950.00	26.00	4,420.00	30.00	5,100.00	34.00	5,780.00
38	1	LS	temp. water srvc Shirley & Fairlawn	15,000.00	15,000.00	6,000.00	6,000.00	10,000.00	10,000.00	20,000.00	20,000.00
39	100	LF	relocate water service	37.00	3,700.00	30.00	3,000.00	40.00	4,000.00	53.00	5,300.00
40	21	EA	install 3/4" water service to exist.	1,000.00	21,000.00	550.00	11,550.00	800.00	16,800.00	775.00	16,275.00
41	600	SY	reconstruct sidewalk or driveway apr.	30.00	18,000.00	18.60	11,160.00	20.00	12,000.00	19.50	11,700.00
42	800	LF	bituminous curb	7.00	5,600.00	6.20	4,960.00	7.00	5,600.00	5.00	4,000.00

Bid #: 2013-015				Longchamps & Sons		Gendron & Gendron		McGee Construction		St. Laurent & Son	
				Lisbon ME		Lewiston ME		West Gardiner ME		Lewiston ME	
#	Qty	Unit	Description	Unit \$	Total \$	Unit \$	Total \$	Unit \$	Total \$	Unit \$	Total \$
43	145	LF	remove/reset exist. Granite curb	35.00	5,075.00	11.00	1,595.00	20.00	2,900.00	25.00	3,625.00
44	2	EA	terminal granite curb 7' circular	350.00	700.00	260.00	520.00	350.00	700.00	475.00	950.00
45	20	SF	detectable warning	75.00	1,500.00	82.00	1,640.00	100.00	2,000.00	65.00	1,300.00
46	1,300	SY	loam, seed & mulch	6.00	7,800.00	5.00	6,500.00	3.00	3,900.00	6.00	7,800.00
47	80	HR	hand labor straight time	1.00	80.00	25.00	2,000.00	35.00	2,800.00	40.00	3,200.00
48	40	HR	mason	1.00	40.00	35.00	1,400.00	40.00	1,600.00	40.00	1,600.00
49	40	HR	foreman	1.00	40.00	40.00	1,600.00	50.00	2,000.00	51.00	2,040.00
50	20	HR	air tool & compressor w/operator	1.00	20.00	55.00	1,100.00	75.00	1,500.00	62.00	1,240.00
51	20	HR	all purpose excavator w/operator	125.00	2,500.00	115.00	2,300.00	100.00	2,000.00	90.00	1,800.00
52	20	HR	truck, small w/operator	1.00	20.00	60.00	1,200.00	60.00	1,200.00	75.00	1,500.00
53	10	HR	front end loader w/operator	100.00	1,000.00	75.00	750.00	75.00	750.00	85.00	850.00
54	1	LS	traffic control	10,000.00	10,000.00	11,750.00	11,750.00	10,000.00	10,000.00	5,000.00	5,000.00
55	1,000	HR	flaggers	18.00	18,000.00	16.00	16,000.00	18.00	18,000.00	18.00	18,000.00
56	1	LS	miscellaneous work	25,000.00	25,000.00	25,800.00	25,800.00	20,000.00	20,000.00	150,000.00	150,000.00
57	1	LS	mobilization & clean up	58,000.00	58,000.00	32,861.80	32,861.80	15,000.00	15,000.00	70,000.00	70,000.00
				1,295,020.00		916,039.00		1,136,350.00		1,297,765.00	
Bid #: 2013-015				C H Stevenson		D & C Construction		Pratt & Sons		K & K Excavation	
				Wayne ME		Waterboro ME		Mechanic Falls ME		Turner ME	
#	Qty	Unit	Description	Unit \$	Total \$	Unit \$	Total \$	Unit \$	Total \$	Unit \$	Total \$
1	2	EA	remove manhole or catch basin	350.00	700.00	100.00	200.00	270.00	540.00	750.00	1,500.00
2	100	CY	Granular borrow	14.00	1,400.00	16.00	1,600.00	30.00	3,000.00	25.00	2,500.00
3	400	CY	crushed stone	26.00	10,400.00	23.00	9,200.00	22.00	8,800.00	40.00	16,000.00
4	20	EA	test pit excavation	400.00	8,000.00	200.00	4,000.00	385.00	7,700.00	950.00	19,000.00
5	100	CY	structural earth ex. Drainage etc.	32.00	3,200.00	0.01	1.00	12.00	1,200.00	50.00	5,000.00
6	1,000	CY	structural rock excavation	220.00	220,000.00	125.00	125,000.00	140.00	140,000.00	195.00	195,000.00
7	500	CY	aggregate base crushed	17.00	8,500.00	23.75	11,875.00	15.00	7,500.00	26.00	13,000.00
8	2,100	CY	aggregate sub-base gravel	16.00	33,600.00	18.75	39,375.00	17.00	35,700.00	22.00	46,200.00
9	5,000	SY	fine grade/prep areas for paving	1.60	8,000.00	3.50	17,500.00	5.50	27,500.00	5.85	29,250.00
10	600	TON	HMA 19.0 mm	84.00	50,400.00	92.50	55,500.00	89.00	53,400.00	95.00	57,000.00
11	220	TON	HMA 9.5 mm	94.50	20,790.00	106.75	23,485.00	100.00	22,000.00	105.00	23,100.00
12	210	TON	HMA 12.5 mm	86.00	18,060.00	91.50	19,215.00	90.00	18,900.00	95.00	19,950.00
13	150	TON	HMA hand placed	110.00	16,500.00	127.00	19,050.00	125.00	18,750.00	130.00	19,500.00
14	320	LF	8" PVC sewer main	60.00	19,200.00	62.00	19,840.00	93.00	29,760.00	45.00	14,400.00
15	380	LF	15" PVC sewer main	74.00	28,120.00	77.00	29,260.00	98.00	37,240.00	55.00	20,900.00
16	1	LS	by pass dumping/sewage flow contr.	11,000.00	11,000.00	2,500.00	2,500.00	5,400.00	5,400.00	28,500.00	28,500.00
17	1	LS	abandonment of sewers	6,000.00	6,000.00	500.00	500.00	6,100.00	6,100.00	5,500.00	5,500.00
18	3	EA	4' dia. Sanitary manhole	3,400.00	10,200.00	3,300.00	9,900.00	3,000.00	9,000.00	4,000.00	12,000.00
19	500	LF	replace exist. 4,6&8" sanit. House lat.	30.50	15,250.00	64.50	32,250.00	46.00	23,000.00	45.00	22,500.00
20	100	LF	relocate existing sewer service	66.00	6,600.00	64.50	6,450.00	99.00	9,900.00	50.00	5,000.00
21	60	LF	6" dis. PVC storm drain	49.00	2,940.00	60.00	3,600.00	50.00	3,000.00	50.00	3,000.00
22	10	LF	8" dia. HDPE storm drain	61.50	615.00	65.00	650.00	54.00	540.00	75.00	750.00

Bid #: 2013-015				C H Stevenson		D & C Construction		Pratt & Sons		K & K Excavation	
				Wayne ME		Waterboro ME		Mechanic Falls ME		Turner ME	
#	Qty	Unit	Description	Unit \$	Total \$	Unit \$	Total \$	Unit \$	Total \$	Unit \$	Total \$
23	760	LF	12" dia. Sanitite storm drain	58.50	44,460.00	67.00	50,920.00	56.00	42,560.00	50.00	38,000.00
24	375	LF	15" dia. Sanitite storm drain	66.00	24,750.00	70.00	26,250.00	72.00	27,000.00	55.00	20,625.00
25	40	LF	18" dia. Sanitite storm drain	71.00	2,840.00	75.00	3,000.00	86.00	3,440.00	65.00	2,600.00
26	70	LF	24" dia. Sanitite storm drain	130.00	9,100.00	82.50	5,775.00	100.00	7,000.00	95.00	6,650.00
27	380	LF	30" dia. Sanitite storm drain	92.00	34,960.00	98.00	37,240.00	139.00	52,820.00	115.00	43,700.00
28	1,575	LF	36" dia. Sanitite storm drain	105.00	165,375.00	158.50	249,637.50	162.00	255,150.00	145.00	228,375.00
29	75	LF	36" dia. ADS-12 storm drain	109.00	8,175.00	158.50	11,887.50	200.00	15,000.00	165.00	12,375.00
30	20	EA	4' dia. Catch basin	2,700.00	54,000.00	4,000.00	80,000.00	2,600.00	52,000.00	3,500.00	70,000.00
31	4	EA	5' dia. Catch basin	4,000.00	16,000.00	5,650.00	22,600.00	3,800.00	15,200.00	8,500.00	34,000.00
32	7	EA	4' dia. Manhole	3,400.00	23,800.00	3,100.00	21,700.00	3,200.00	22,400.00	3,500.00	24,500.00
33	7	EA	5' dia. Manhole	4,300.00	30,100.00	5,550.00	38,850.00	4,500.00	31,500.00	8,000.00	56,000.00
34	3	EA	6' dia. Manhole	10,000.00	30,000.00	7,200.00	21,600.00	6,000.00	18,000.00	11,500.00	34,500.00
35	6	EA	alter catch basin or manhole	1,100.00	6,600.00	500.00	3,000.00	1,600.00	9,600.00	1,250.00	7,500.00
36	520	LF	install 6" DI Water main	26.00	13,520.00	27.50	14,300.00	46.00	23,920.00	55.00	28,600.00
37	170	LF	install 8" DI Water main	28.00	4,760.00	27.50	4,675.00	84.00	14,280.00	60.00	10,200.00
38	1	LS	temp. water svcs Shirley & Fairlawn	7,200.00	7,200.00	18,560.00	18,560.00	19,000.00	19,000.00	15,500.00	15,500.00
39	100	LF	relocate water service	40.00	4,000.00	27.50	2,750.00	78.00	7,800.00	70.00	7,000.00
40	21	EA	install 3/4" water service to exist.	1,100.00	23,100.00	900.00	18,900.00	1,300.00	27,300.00	800.00	16,800.00
41	600	SY	reconstruct sidewalk or driveway apr.	6.00	3,600.00	35.00	21,000.00	19.00	11,400.00	24.50	14,700.00
42	800	LF	bituminous curb	8.00	6,400.00	5.75	4,600.00	7.00	5,600.00	7.00	5,600.00
43	145	LF	remove/reset exist. Granite curb	16.50	2,392.50	20.00	2,900.00	18.00	2,610.00	20.00	2,900.00
44	2	EA	terminal granite curb 7' circular	270.00	540.00	350.00	700.00	290.00	580.00	350.00	700.00
45	20	SF	detectable warning	40.00	800.00	250.00	5,000.00	78.00	1,560.00	95.00	1,900.00
46	1,300	SY	loam, seed & mulch	7.00	9,100.00	5.50	7,150.00	6.00	7,800.00	4.85	6,305.00
47	80	HR	hand labor straight time	40.00	3,200.00	35.00	2,800.00	28.00	2,240.00	40.00	3,200.00
48	40	HR	mason	45.00	1,800.00	45.00	1,800.00	53.00	2,120.00	50.00	2,000.00
49	40	HR	foreman	50.00	2,000.00	50.00	2,000.00	60.00	2,400.00	55.00	2,200.00
50	20	HR	air tool & compressor w/operator	50.00	1,000.00	50.00	1,000.00	65.00	1,300.00	65.00	1,300.00
51	20	HR	all purpose excavator w/operator	120.00	2,400.00	100.00	2,000.00	123.00	2,460.00	150.00	3,000.00
52	20	HR	truck, small w/operator	65.00	1,300.00	50.00	1,000.00	65.00	1,300.00	75.00	1,500.00
53	10	HR	front end loader w/operator	60.00	600.00	75.00	750.00	90.00	900.00	100.00	1,000.00
54	1	LS	traffic control	19,000.00	19,000.00	14,000.00	14,000.00	20,000.00	20,000.00	25,000.00	25,000.00
55	1,000	HR	flaggers	18.00	18,000.00	18.00	18,000.00	16.00	16,000.00	18.00	18,000.00
56	1	LS	miscellaneous work	17,000.00	17,000.00	35,000.00	35,000.00	55,000.00	55,000.00	13,700.00	13,700.00
57	1	LS	mobilization & clean up	150,000.00	150,000.00	35,000.00	35,000.00	81,000.00	81,000.00	128,500.00	128,500.00
				1,241,347.50		1,217,296.00		1,327,170.00		1,447,980.00	

City of LEWISTON *Maine*



DEPARTMENT OF
PUBLIC WORKS

ENGINEERING DIVISION

103 ADAMS AVENUE
LEWISTON, MAINE 04240
Tel. 207 513-3003 FAX 207 784-5647

MARCH, 2013

PUBLIC WORKS DIRECTOR

David A. Jones

David A. Jones, P.E.

CITY ENGINEER

Richard C. Burnham

Richard C. Burnham, P.E.



LOCUS MAP
1" = 200'

JEPSON BROOK CSO PHASE III
BELLEGARDE, SHIRLEY & FAIRLAWN AVENUES,
SABATTUS & JEAN STREETS AND BELLEGARDE CIRCLE

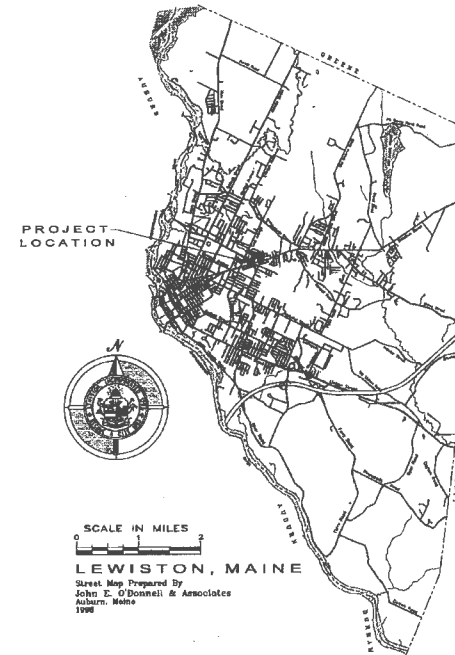

SCALE IN MILES
0 1 2

LEWISTON, MAINE

Street Map Prepared By
John E. O'Donnell & Associates
Auburn, Maine
1998

SHEET INDEX:

SHEET	DESCRIPTION
1	COVER SHEET
2	NOTES AND LEGEND
3 & 4	DETAILS
5	PLAN & PROFILE: BELLEGARDE AVENUE STA 481+10 TO 574+00
6	PLAN & PROFILE: BELLEGARDE CIRCLE STA 481+10 TO 513+75
7	PLAN & PROFILE: SHIRLEY AVENUE STA 481+10 TO 524+00
8	PLAN & PROFILE: FAIRLAWN AVENUE STA 481+10 TO 534+00
9	PLAN & PROFILE: FAIRLAWN AVENUE STA 481+10 TO 534+00
10	PLAN & PROFILE: FAIRLAWN AVENUE STA 481+10 TO 534+00
11	PLAN & PROFILE: SABATTUS STREET STA 481+10 TO 534+00
12	PLAN & PROFILE: JEAN STREET STA 481+10 TO 534+00
13	PLAN & PROFILE: JEAN STREET STA 481+10 TO 534+00

SEBAGO
TECHNICAL

77 John Pursh Rd. - Suite 5A
South Portland, ME 04086
Tel. 877-822-1180



FILE No.



Finance Committee

Norman J. Beuparlant
Director of Budget/Purchasing
nbeuparlant@lewistonmaine.gov



Item # 5

to: Finance Committee
from: Norman Beuparlant, Purchasing Director
subject: Bid 2013-019 Jepson Brook Sewer Separation Phase IV
date: May 6, 2013

Bids were opened on April 25, 2013 for the Jepson Brook Sewer Separation Phase IV Project.

It is recommended that the bid be awarded to Longchamps & Sons, Lisbon, Maine, low bidder at their bid price of \$597,335 based on estimated quantities.

Note: the project area is shown on the attached plan sheet.

NJB/syt



Department of Public Works

David A. Jones, PE
Director



DATE: May 2, 2013

TO: Norman Beauparlant, Director of Budget/Purchasing

FROM: Ryan Barnes, P.E., Project Engineer

SUBJECT: Jepson Brook CSO Phase III & Phase IV Projects

Bid 2013-015 and 2013-019

1. Recommend awarding the contract for **Jepson Brook Phase III** to Gendron & Gendron of Lewiston at their bid price of \$916,039.00. The project will be fully funded through the Jepson Brook Stormwater and Sewer accounts. A copy of the bid tabulation for the project is attached for your reference.
2. Recommend awarding the contract for **Jepson Brook Phase IV** to Longchamps & Sons of Lisbon at their bid price of \$597,335.00. The CSO separation portion of the project will be fully funded through the Jepson Brook Stormwater and Sewer accounts and the Water work will be fully funded through the 2013 water bond. A copy of the bid tabulation for the project is attached for your reference.
3. Recommend awarding the task order for the **Construction Phase Services for Jepson Brook Phase III & IV** to Gorrill Palmer Consulting Engineers of Gray at their proposal price of \$88,750.00. The project will be fully funded through the Jepson Brook Stormwater and Sewer accounts. A copy of the proposal for the project is attached for your reference.

A complete breakdown of the funding for the above referenced projects is shown below:

Account Summary – Jepson Brook

642 6422202 – Jepson Brook Stormwater 2012	\$ 325,300.00
622 6222202 – Jepson Brook Sewer 2012	\$ 268,880.00
643 6433404 – Jepson Brook Stormwater 2013	\$ 1,000,000.00
623 6233404 – Jepson Brook Sewer 2013	\$ 1,000,000.00
Account Balance	\$ 2,594,180.00
Phase III – Construction (Contractor)	\$ 916,039.00
Phase IV – Construction – Longchamps & Sons	\$ 480,757.75
Construction Inspection – Gorrill-Palmer	\$ 88,750.00
Balance	\$ 1,108,633.25

Account Summary – Little/Googin Water

Account Balance	\$ 229,775.00
Little Googin Water – Longchamps & Sons	\$ 116,577.25
Balance	\$ 113,197.75

CITY OF LEWISTON
DEPARTMENT OF PUBLIC WORKS
ENGINEERING DIVISION

103 ADAMS AVENUE
 LEWISTON, MAINE 04240
 TEL. (207) 513-3003
 FAX (207) 784-5647



INDEX OF SHEETS

NOTES
 DETAILS
 PLANS

N-1
 D-1 TO D-2
 P-1 TO P-12

PUBLIC WORKS DIRECTOR

David A. Jones
 David A. Jones, P.E.

CITY ENGINEER

Richard C. Burnham
 Richard C. Burnham, P.E.

PROJECT ENGINEER

Jeffrey D. Beaulé, P.E.

APRIL 2013



**JEPSON BROOK SEWER SEPARATION
 PHASE IV**

LITTLE ST, GOOGIN ST, PETTINGILL ST, NO. BARDWELL ST,
 MARBLE ST, RICHMOND AVE, COLLEGE ST

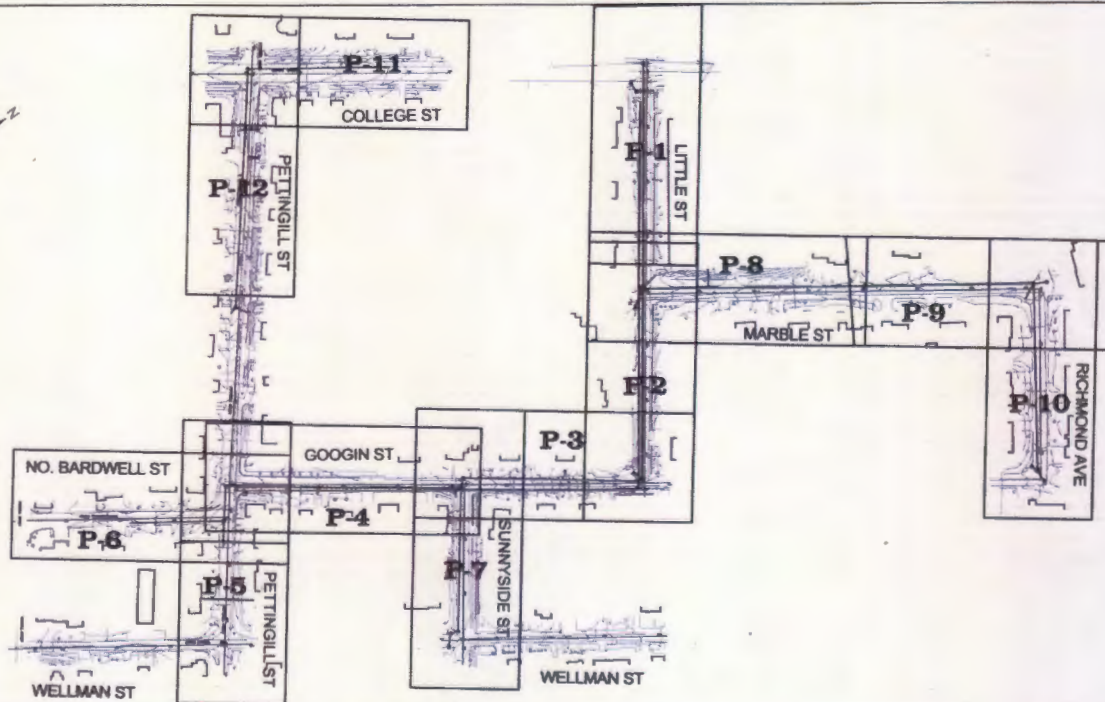

Jepson Brook Sewer Separation Phase IV

Bid #: 2013-019				Longchamps & Sons		Gendron & Gendron		McGee Construction		St. Laurent & Son		Pratt & Sons	
Part 1: Water Main Replacement				Lisbon ME		Lewiston ME		West Gardiner ME		Lewiston ME		Mechanic Falls ME	
#	Qty	Unit	Description	Unit \$	Total \$	Unit \$	Total \$	Unit \$	Total \$	Unit \$	Total \$	Unit \$	Total \$
1	1,500	LF	install 6" - 8" water main	24.99	\$ 37,485.00	22.00	33,000.00	38.00	57,000.00	29.00	43,500.00	25.00	37,500.00
2	2	EA	install hydrant	1,200.00	2,400.00	800.00	1,600.00	2,000.00	4,000.00	880.00	1,760.00	1,000.00	2,000.00
3	16	EA	install/reconnect 3/4" water service	750.00	12,000.00	500.00	8,000.00	800.00	12,800.00	890.00	14,240.00	1,200.00	19,200.00
4	15	CY	rock & boulder excavation	100.00	1,500.00	0.01	0.15	50.00	750.00	0.01	0.15	100.00	1,500.00
5	225	CY	Aggregate base	12.00	2,700.00	16.00	3,600.00	18.00	4,050.00	19.50	4,387.50	17.00	3,825.00
6	450	CY	aggregate sub-base	12.00	5,400.00	15.00	6,750.00	20.00	9,000.00	17.50	7,875.00	14.00	6,300.00
7	100	CY	select backfill	10.00	1,000.00	13.00	1,300.00	10.00	1,000.00	10.00	1,000.00	8.00	800.00
8	260	TON	F/I 19 mm hot mix asphalt	82.00	21,320.00	79.00	20,540.00	90.00	23,400.00	79.00	20,540.00	85.00	22,100.00
9	130	TON	F/I 9.5 mm hot mix asphalt	101.00	13,130.00	98.00	12,740.00	90.00	11,700.00	98.00	12,740.00	93.00	12,090.00
10	50	TON	F/I 9.5 mm HMA hand placed	125.00	6,250.00	115.00	5,750.00	130.00	6,500.00	120.00	6,000.00	113.00	5,650.00
11	1	LS	Miscellaneous work	2,500.00	2,500.00	11,060.00	11,060.00	7,800.00	7,800.00	6,000.00	6,000.00	10,000.00	10,000.00
12	1	LS	Mobilization and Cleanup	4,942.25	4,942.25	4,200.00	4,200.00	7,800.00	7,800.00	9,000.00	9,000.00	7,000.00	7,000.00
13	200	SY	Loam & seed	3.50	700.00	4.50	900.00	5.00	1,000.00	5.00	1,000.00	6.00	1,200.00
14	1,400	SY	Prepare trench & sidewalk for paving	3.75	5,250.00	5.70	7,980.00	5.00	7,000.00	5.00	7,000.00	6.00	8,400.00
Part 1: Water Main Replacement Total				\$ 116,577.25		\$ 117,420.15		\$ 153,800.00		\$ 135,042.65		\$ 137,565.00	
Bid #: 2013-019				Longchamps & Sons		Gendron & Gendron		McGee Construction		St. Laurent & Son		Pratt & Sons	
Part 2: Storm Drain				Lisbon ME		Lewiston ME		West Gardiner ME		Lewiston ME		Mechanic Falls ME	
#	Qty	Unit	Description	Unit \$	Total \$	Unit \$	Total \$	Unit \$	Total \$	Unit \$	Total \$	Unit \$	Total \$
1	50	LF	F/I 6" catch basin lead	27.00	1,350.00	30.00	1,500.00	30.00	1,500.00	34.00	1,700.00	46.00	2,300.00
2	350	LF	F/I 8" catch basin lead	27.00	9,450.00	35.00	12,250.00	38.00	13,300.00	35.00	12,250.00	38.00	13,300.00
3	1,075	LF	F/I 12" storm drain	31.57	33,937.75	30.00	32,250.00	40.00	43,000.00	43.18	46,418.50	41.00	44,075.00
4	1,450	LF	F/I 15" storm drain	39.00	56,550.00	37.00	53,650.00	42.00	60,900.00	45.10	65,395.00	47.00	68,150.00
5	825	LF	F/I 18" storm drain	42.50	35,062.50	41.00	33,825.00	50.00	41,250.00	50.28	41,481.00	55.00	45,375.00
6	350	LF	F/I 24" storm drain	50.00	17,500.00	51.00	17,850.00	55.00	19,250.00	56.80	19,880.00	69.00	24,150.00
7	415	LF	F/I 30" storm drain	71.50	29,672.50	66.50	27,597.50	60.00	24,900.00	79.35	32,930.25	90.00	37,350.00
8	10	LF	F/I 36" storm drain	200.00	2,000.00	137.00	1,370.00	100.00	1,000.00	205.00	2,050.00	129.00	1,290.00
9	14	EA	F/I 4' dia. Catch basin	2,600.00	36,400.00	2,055.00	28,770.00	3,000.00	42,000.00	2,410.00	33,740.00	2,200.00	30,800.00
10	15	EA	F/I 4' dia. Storm drain manhole	3,300.00	49,500.00	2,400.00	36,000.00	3,200.00	48,000.00	3,200.00	48,000.00	3,100.00	46,500.00
11	2	EA	F/I 5' dia. Storm drain manhole	3,500.00	7,000.00	2,700.00	5,400.00	4,000.00	8,000.00	3,500.00	7,000.00	4,100.00	8,200.00
12	25	CY	Rock & boulder excavation	1.00	25.00	0.01	0.25	50.00	1,250.00	100.00	2,500.00	100.00	2,500.00
13	825	CY	Aggregate Base	12.00	9,900.00	17.00	14,025.00	18.00	14,850.00	19.50	16,087.50	17.00	14,025.00
14	1,650	CY	Aggregate sub-base	12.00	19,800.00	15.00	24,750.00	16.00	26,400.00	17.50	28,875.00	14.00	23,100.00
15	300	CY	Select backfill	10.00	3,000.00	13.80	4,140.00	10.00	3,000.00	10.00	3,000.00	8.00	2,400.00
16	775	TON	F/I 19 mm Hot mix asphalt	82.00	63,550.00	79.00	61,225.00	90.00	69,750.00	79.00	61,225.00	85.00	65,875.00
17	390	TON	F/I 9.5 mm hot mix asphalt	101.00	39,390.00	98.00	38,220.00	90.00	35,100.00	98.00	38,220.00	93.00	36,270.00
18	125	TON	F/I 9.5 mm HMA hand placed	125.00	15,625.00	115.00	14,375.00	130.00	16,250.00	120.00	15,000.00	113.00	14,125.00
19	300	LF	F/I Bituminuous curb	13.00	3,900.00	15.00	4,500.00	10.00	3,000.00	15.00	4,500.00	12.00	3,600.00
20	1	LS	Miscellaneous work	10,000.00	10,000.00	10,900.00	10,900.00	7,000.00	7,000.00	6,000.00	6,000.00	50,000.00	50,000.00
21	1	LS	Mobilization and Cleanup	10,000.00	10,000.00	18,934.87	18,934.87	7,000.00	7,000.00	15,000.00	15,000.00	24,000.00	24,000.00
22	700	SY	Loam & seed	3.50	2,450.00	4.50	3,150.00	4.00	2,800.00	5.00	3,500.00	6.00	4,200.00
23	4,900	SY	Prepare trench & sidewalk for paving	3.75	18,375.00	4.60	22,540.00	3.00	14,700.00	5.00	24,500.00	6.00	29,400.00

				Longchamps & Sons		Gendron & Gendron		McGee Construction		St. Laurent & Son		Pratt & Sons	
				Lisbon ME		Lewiston ME		West Gardiner ME		Lewiston ME		Mechanic Falls ME	
24	150	HR	Flagger	17.00	2,550.00	16.00	2,400.00	18.00	2,700.00	15.00	2,250.00	15.00	2,250.00
25	50	HR	Hand labor	1.00	50.00	25.00	1,250.00	40.00	2,000.00	35.00	1,750.00	25.00	1,250.00
26	25	HR	Foreman	1.00	25.00	35.00	875.00	50.00	1,250.00	40.00	1,000.00	55.00	1,375.00
27	20	HR	Air tool & compressor w/operator	1.00	20.00	15.00	300.00	65.00	1,300.00	40.00	800.00	65.00	1,300.00
28	25	HR	All purpose excavator	1.00	25.00	100.00	2,500.00	120.00	3,000.00	90.00	2,250.00	115.00	2,875.00
29	25	HR	Truck w/operator	1.00	25.00	65.00	1,625.00	60.00	1,500.00	75.00	1,875.00	65.00	1,625.00
30	25	HR	Front End Loader w/operator	1.00	25.00	65.00	1,625.00	80.00	2,000.00	80.00	2,000.00	85.00	2,125.00
31	80	LF	F/I 6" PVC Sewer/Storm service	45.00	3,600.00	32.00	2,560.00	40.00	3,200.00	50.00	4,000.00	140.00	11,200.00
Part 2: Storm Drain Total				480,757.75		480,357.62		521,150.00		545,177.25		614,985.00	
TOTAL PART 1 AND PART 2				\$ 597,335.00		\$ 597,777.77		\$ 674,950.00		\$ 680,219.90		\$ 752,550.00	
Bid #: 2013-019				C H Stevenson		K & K Excavation		T-Buck Construction		Trombley Construction			
Part 1: Water Main Replacement				Wayne ME		Turner ME		Auburn ME		Presque Isle ME			
#	Qty	Unit	Description	Unit \$	Total \$	Unit \$	Total \$	Unit \$	Total \$	Unit \$	Total \$		
1	1,500	LF	install 6" - 8" water main	26.00	\$ 39,000.00	35.00	52,500.00	35.00	52,500.00	50.00	75,000.00		
2	2	EA	install hydrant	2,000.00	4,000.00	1,800.00	3,600.00	2,000.00	4,000.00	2,200.00	4,400.00		
3	16	EA	install/reconnect 3/4" water service	875.00	14,000.00	580.00	9,280.00	1,000.00	16,000.00	800.00	12,800.00		
4	15	CY	rock & boulder excavation	150.00	2,250.00	200.00	3,000.00	100.00	1,500.00	150.00	2,250.00		
5	225	CY	Aggregate base	16.00	3,600.00	26.85	6,041.25	18.00	4,050.00	21.00	4,725.00		
6	450	CY	aggregate sub-base	15.00	6,750.00	24.50	11,025.00	16.00	7,200.00	21.00	9,450.00		
7	100	CY	select backfill	13.00	1,300.00	19.00	1,900.00	11.00	1,100.00	18.00	1,800.00		
8	260	TON	F/I 19 mm hot mix asphalt	92.50	24,050.00	85.00	22,100.00	85.00	22,100.00	125.00	32,500.00		
9	130	TON	F/I 9.5 mm hot mix asphalt	103.00	13,390.00	105.00	13,650.00	110.00	14,300.00	125.00	16,250.00		
10	50	TON	F/I 9.5 mm HMA hand placed	126.00	6,300.00	130.00	6,500.00	130.00	6,500.00	150.00	7,500.00		
11	1	LS	Miscellaneous work	3,700.00	3,700.00	7,400.00	7,400.00	4,000.00	4,000.00	4,800.00	4,800.00		
12	1	LS	Mobilization and Cleanup	17,000.00	17,000.00	6,500.00	6,500.00	8,000.00	8,000.00	8,950.00	8,950.00		
13	200	SY	Loam & seed	13.00	2,600.00	6.50	1,300.00	6.00	1,200.00	7.50	1,500.00		
14	1,400	SY	Prepare trench & sidewalk for paving	2.25	3,150.00	8.50	11,900.00	4.00	5,600.00	7.50	10,500.00		
Part 1: Water Main Replacement Total				\$ 141,090.00		\$ 156,696.25		\$ 148,050.00		\$ 192,425.00			
Bid #: 2013-019				C H Stevenson		K & K Excavation		T-Buck Construction		Trombley Construction			
Part 2: Storm Drain				Wayne ME		Turner ME		Auburn ME		Presque Isle ME			
#	Qty	Unit	Description	Unit \$	Total \$	Unit \$	Total \$	Unit \$	Total \$	Unit \$	Total \$		
1	50	LF	F/I 6" catch basin lead	24.00	1,200.00	38.50	1,925.00	50.00	2,500.00	55.00	2,750.00		
2	350	LF	F/I 8" catch basin lead	26.00	9,100.00	50.00	17,500.00	50.00	17,500.00	60.00	21,000.00		
3	1,075	LF	F/I 12" storm drain	46.00	49,450.00	40.00	43,000.00	55.00	59,125.00	45.00	48,375.00		
4	1,450	LF	F/I 15" storm drain	49.00	71,050.00	45.00	65,250.00	60.00	87,000.00	50.00	72,500.00		
5	825	LF	F/I 18" storm drain	54.00	44,550.00	50.00	41,250.00	65.00	53,625.00	55.00	45,375.00		
6	350	LF	F/I 24" storm drain	61.00	21,350.00	60.00	21,000.00	70.00	24,500.00	70.00	24,500.00		
7	415	LF	F/I 30" storm drain	83.00	34,445.00	80.00	33,200.00	75.00	31,125.00	90.00	37,350.00		
8	10	LF	F/I 36" storm drain	162.00	1,620.00	165.00	1,650.00	175.00	1,750.00	150.00	1,500.00		
9	14	EA	F/I 4' dia. Catch basin	2,500.00	35,000.00	3,000.00	42,000.00	3,500.00	49,000.00	2,900.00	40,600.00		
10	15	EA	F/I 4' dia. Storm drain manhole	3,100.00	46,500.00	3,500.00	52,500.00	3,500.00	52,500.00	3,000.00	45,000.00		

				C H Stevenson		K & K Excavation		T-Buck Construction		Trombley Construction			
				Wayne ME		Turner ME		Auburn ME		Presque Isle ME			
11	2	EA	F/I 5' dia. Storm drain manhole	4,700.00	9,400.00	5,850.00	11,700.00	4,000.00	8,000.00	3,500.00	7,000.00		
12	25	CY	Rock & boulder excavation	150.00	3,750.00	200.00	5,000.00	100.00	2,500.00	100.00	2,500.00		
13	825	CY	Aggregate Base	16.00	13,200.00	24.00	19,800.00	18.00	14,850.00	21.00	17,325.00		
14	1,650	CY	Aggregate sub-base	15.00	24,750.00	22.00	36,300.00	16.00	26,400.00	21.00	34,650.00		
15	300	CY	Select backfill	13.00	3,900.00	19.00	5,700.00	11.00	3,300.00	18.00	5,400.00		
16	775	TON	F/I 19 mm Hot mix asphalt	92.50	71,687.50	85.00	65,875.00	82.00	63,550.00	125.00	96,875.00		
17	390	TON	F/I 9.5 mm hot mix asphalt	103.00	40,170.00	105.00	40,950.00	105.00	40,950.00	125.00	48,750.00		
18	125	TON	F/I 9.5 mm HMA hand placed	126.00	15,750.00	125.00	15,625.00	120.00	15,000.00	150.00	18,750.00		
19	300	LF	F/I Bituminuous curb	7.50	2,250.00	16.50	4,950.00	9.00	2,700.00	20.00	6,000.00		
20	1	LS	Miscellaneous work	15,300.00	15,300.00	31,500.00	31,500.00	35,446.00	35,446.00	17,000.00	17,000.00		
21	1	LS	Mobilization and Cleanup	34,625.00	34,625.00	21,000.00	21,000.00	13,000.00	13,000.00	31,800.00	31,800.00		
22	700	SY	Loam & seed	9.00	6,300.00	6.50	4,550.00	5.00	3,500.00	7.50	5,250.00		
23	4,900	SY	Prepare trench & sidewalk for paving	12.00	58,800.00	5.50	26,950.00	3.00	14,700.00	9.00	44,100.00		
24	150	HR	Flagger	23.00	3,450.00	18.50	2,775.00	15.00	2,250.00	20.00	3,000.00		
25	50	HR	Hand labor	40.00	2,000.00	35.00	1,750.00	35.00	1,750.00	25.00	1,250.00		
26	25	HR	Foreman	50.00	1,250.00	48.50	1,212.50	55.00	1,375.00	25.00	625.00		
27	20	HR	Air tool & compressor w/operator	50.00	1,000.00	65.00	1,300.00	70.00	1,400.00	40.00	800.00		
28	25	HR	All purpose excavator	115.00	2,875.00	120.00	3,000.00	115.00	2,875.00	70.00	1,750.00		
29	25	HR	Truck w/operator	65.00	1,625.00	72.00	1,800.00	75.00	1,875.00	60.00	1,500.00		
30	25	HR	Front End Loader w/operator	70.00	1,750.00	95.00	2,375.00	90.00	2,250.00	50.00	1,250.00		
31	80	LF	F/I 6" PVC Sewer/Storm service	23.00	1,840.00	40.00	3,200.00	56.00	4,480.00	70.00	5,600.00		
Part 2: Storm Drain Total				629,937.50		626,587.50		640,776.00		690,125.00			
TOTAL PART 1 AND PART 2				\$ 771,027.50		\$ 783,283.75		\$ 788,826.00		\$ 882,550.00			



Finance Committee

Norman J. Beuparlant
Director of Budget/Purchasing
nbeuparlant@lewistonmaine.gov



Item # 6

to: Finance Committee
from: Norman Beuparlant, Purchasing Director
subject: Task Order with Gorrill-Palmer Consulting
date: May 6, 2013

Gorrill-Palmer will provide construction inspection on Phase III and Phase IV of the Jepson Brook Sewer Separation Projects.

The estimated value of the Task Order is \$88,750 with funding as shown.

It is recommended that the Task Order be authorized at this time in the amount not to exceed \$88,750.

NJB/syt



Department of Public Works

David A. Jones, PE
Director



DATE: May 2, 2013

TO: Norman Beauparlant, Director of Budget/Purchasing

FROM: Ryan Barnes, P.E., Project Engineer

SUBJECT: Jepson Brook CSO Phase III & Phase IV Projects

Bid 2013-015 and 2013-019

1. Recommend awarding the contract for **Jepson Brook Phase III** to Gendron & Gendron of Lewiston at their bid price of \$916,039.00. The project will be fully funded through the Jepson Brook Stormwater and Sewer accounts. A copy of the bid tabulation for the project is attached for your reference.
2. Recommend awarding the contract for **Jepson Brook Phase IV** to Longchamps & Sons of Lisbon at their bid price of \$597,335.00. The CSO separation portion of the project will be fully funded through the Jepson Brook Stormwater and Sewer accounts and the Water work will be fully funded through the 2013 water bond. A copy of the bid tabulation for the project is attached for your reference.
3. Recommend awarding the task order for the **Construction Phase Services for Jepson Brook Phase III & IV** to Gorrill Palmer Consulting Engineers of Gray at their proposal price of \$88,750.00. The project will be fully funded through the Jepson Brook Stormwater and Sewer accounts. A copy of the proposal for the project is attached for your reference.

A complete breakdown of the funding for the above referenced projects is shown below:

Account Summary – Jepson Brook

642 6422202 – Jepson Brook Stormwater 2012	\$ 325,300.00
622 6222202 – Jepson Brook Sewer 2012	\$ 268,880.00
643 6433404 – Jepson Brook Stormwater 2013	\$ 1,000,000.00
623 6233404 – Jepson Brook Sewer 2013	\$ 1,000,000.00
Account Balance	\$ 2,594,180.00
Phase III – Construction (Contractor)	\$ 916,039.00
Phase IV – Construction – Longchamps & Sons	\$ 480,757.75
Construction Inspection – Gorrill-Palmer	\$ 88,750.00
Balance	\$ 1,108,633.25

Account Summary – Little/Googin Water

Account Balance	\$ 229,775.00
Little Googin Water – Longchamps & Sons	\$ 116,577.25
Balance	\$ 113,197.75



April 25, 2013 (Revised)

Mr. Ryan Barnes, PE
City of Lewiston
Public Works Department
103 Adams Avenue
Lewiston, ME 04240

Subject: Proposal for Construction Phase Services
Jepson Brook Sewer Separation – Phases III & IV

Dear Ryan,

This letter transmits our proposal for construction phase services for the Jepson Brook Sewer Separation Phases III & IV project. We have enjoyed working with the Public Works Department on several other construction projects and we are pleased to submit the proposal for the construction phase services. Attached to this letter is the scope of services.

Gorrill-Palmer will perform these services with reasonable diligence and expediency consistent with sound professional practices. All work would be completed in accordance with the Agreement between the City of Lewiston and Gorrill-Palmer executed on April 5, 2012.

Gorrill-Palmer Consulting Engineers Inc. would provide the attached scope of services for an estimated not to exceed fee as follows:

- FY 2013 Construction (May – Jun): \$24,490.00
- FY 2014 Construction (Jul – Oct): \$64,260.00
- Total Estimated Construction Fee: \$88,750.00

A tabulation of the estimated fee and expenses is also attached to this proposal. As neither Gorrill-Palmer Consulting Engineers Inc. nor the City can determine the exact number of weeks or the hours per week that the Contractor would use to construct the project, we recommend proceeding based on an hourly rate basis plus expenses basis. This proposal assumes, at the request of the City, that one inspector will split their time between both projects, resulting in part-time observation coverage for each project. The budget for this work is based on 25 total weeks of construction, assuming a start around May 13, 2013 and estimated completion by October 31, 2013. We have assumed 50 hours per week, which includes time on site, report preparation, quantity tracking and travel time to and from the office (if necessary).

We look forward to discussing this project further with you.

Sincerely,

Gorrill-Palmer Consulting Engineers, Inc.

William C. Haskell, PE
Vice President

City of Lewiston

Authorized Signature Date

Printed Name & Title

Enc.

**Proposal for Civil Engineering Services
Jepson Brook Sewer Separation Phases III & IV
Construction Phase Services
April 25, 2013 (Revised)**

Project Understanding

This proposal includes scope for construction phase services for both Jepson Brook Sewer Separation Phase III & IV. We have assumed, at the request of the City, that one inspector would split their time between both projects, resulting in part-time observation coverage for each project. We would suggest that there may be critical times where it would be beneficial to have an inspector at each project, such as if paving is occurring simultaneously on both projects. We will coordinate and discuss those situations with you as they occur.

The bid dates for Jepson Brook Phase IV and Phase III is April 25, 2013 and May 2, 2013, respectively. The Contract Documents require the Contractor to be substantially complete on Jepson Brook Phase IV and Phase III (including paving) by October 4 and October 31, 2013, respectively. Based on the Contract Documents we have assumed that the project would start as early as May 13, 2013, and may require up to 25 weeks of construction (to October 31, 2013). We have assumed 50 hours per week, which includes time on site, report preparation, quantity tracking and travel time to and from the office (if necessary).

Scope of Work

Gorrill-Palmer Consulting Engineers, Inc. (GP) would complete the following services as part of the construction phase:

1. Attend pre-construction conference.
2. In connection with observations of the work while it is in progress, conduct full-time daily site inspections in order to observe, as an experienced and qualified design professional, the progress and quality of the work. Based on information obtained during our observations, GP will determine if the Work is proceeding in general accordance with the Contract Documents, and shall inform the City of the progress of the work.
3. Prepare Daily Field Reports in a manner acceptable to the City. Based on discussions with the City these will consist of scans of daily field book notes.
4. Maintain a daily log of work completed based on the contract items and units. Review quantities on a daily basis with the Contractor's Superintendent.
5. Recommend to the City that the Work be disapproved and rejected while it is in progress if GP believes that such Work will not produce a completed Project that

Mr. Ryan Barnes, PE
April 25, 2013 (Revised)
Page 2 of 3

conforms generally to the Contract Documents or that it will prejudice the integrity of the design concept of the completed Project as a functioning whole as indicated in the Contract Documents.

6. During the course of the work, coordinate with the City's Project Manager and as appropriate request clarifications and interpretations of the Contract Documents.
7. Consult with and advise the City concerning, and determining the acceptability of, substitute materials, and equipment proposed by Contractor.
8. Monitor the Contractor's progress in maintaining service lateral cards during the course of the work.
9. Make recommendations to the City concerning special inspections or tests of the Work, and the receipt and review of all certificates of inspections, testing, and approvals required by Laws and Regulations and the Contract Documents.
10. Assist the City in rendering formal written decisions on all claims of Owner and Contractor relating to acceptability of the Work or the interpretation of the requirements of the Contract Documents pertaining to the execution and progress of the Work. In assisting in such decisions, GP shall be fair and not show partiality to the Owner or Contractor and shall not be liable in connection with any decision rendered in good faith.
11. Based on on-site observations, review Applications for Payment and supporting documentation.
12. After notice from Contractor that the Work for This Part of the Project is ready for its intended use, in company with the City and Contractor, conduct an inspection to determine if the Work is Substantially Complete. Provide recommendation to the City relative to issuance of the Certificate of Substantial Completion.
13. Assist the City in conducting a final inspection to determine if the completed Work is acceptable so that GP may recommend, in writing, that final payment be made to the Contractor.
14. Assist the City in assembling the close out documents at the conclusion of the project.

Assigned Personnel

Based on the status and schedule of several other ongoing construction projects and the uncertain start date of this project, we do not currently know who will be assigned to this project. Our firm has previously served as the Construction Monitor on several City of Lewiston projects and we have a number of individuals available for assignment dependent

*Mr. Ryan Barnes, PE
April 25, 2013 (Revised)
Page 3 of 3*

on the actual start date. Will Haskell would serve as the Principal/Project Manager for the project. Will Haskell would coordinate with the City's Project Manager to make sure that the City's needs were being met as well as periodically visiting the project site to check in with the inspector and to observe the construction. Al Palmer would also assist with quality control and occasional site visits. We will endeavor to keep the assigned inspector on the project throughout the project construction, except when he is sick, scheduled for training or has a previous scheduled vacation day. On any days that the assigned individual is away, Gorrill-Palmer would use staff with equivalent experience to perform the Construction Observations.

Schedule

We have assumed 25 weeks of construction at 50 hours per week. The estimated hours per week include time on site, report preparation, quantity tracking and travel time to and from the office (if necessary).

GORRILL-PALMER CONSULTING ENGINEERS, INC. P.O. Box 1237 GRAY, MAINE 04039 (207) 657-6910 FAX (207) 657-6912	2648.05 Jepson Brook Sewer Separation Phases III & IV <hr/> JOB SHEET NO. <u>1</u> OF <u>1</u> CALCULATED BY <u>WCH</u> DATE <u>rev 04-25-2013</u> CHECKED BY <u>AMP</u> DATE <u>4/22/2013</u> SCALE <u>N/A</u>
--	---

Task: Calculate Person Hours and Costs for Construction Observations

Assumptions: Hourly Rates - City of Lewiston

Assumed Schedule (total weeks) 25 assumed 5/6/13 - 10/31/13

FY 2013 May - Jun weeks 7 5/13/13 - 6/28/13

FY 2014 Jul - Oct weeks 18 7/1/13 - 10/31/13

0 weeks for cleanup and final paving in fall 2013

Hours of Observations Per Week 50 hours from start of project for assumed schedule

	Principal	Prof. Engineer	Staff Engineer	Construction Observer	CAD	
Rate	\$125.00	\$90.00	\$70.00	\$65.00	\$70.00	
Task						
FY 2013 Const	0	10	0	350	0	
Labor Fee	\$0.00	\$900.00	\$0.00	\$22,750.00	\$0.00	\$23,650.00
Mileage						\$690.00
Other Direct Job Costs						\$150.00
Subtotal FY 2013						\$24,490.00
FY 2014 Const	0	40	0	900	0	
Labor Fee	\$0.00	\$3,600.00	\$0.00	\$58,500.00	\$0.00	\$62,100.00
Mileage						\$1,780.00
Other Direct Job Costs						\$380.00
Subtotal FY 2014						\$64,260.00
Total Estimated Fee for Project						\$88,750.00



Finance Committee

Norman J. Beuparlant
 Director of Budget/Purchasing
 nbeuparlant@lewistonmaine.gov



Item # 7

to: Finance Committee
from: Norman Beuparlant, Purchasing Director
subject: Bid 2013-021 Tax Bill Outsourcing and Bid 2013-022 Water, Sewer & Storm Water Bill Outsourcing
date: May 6, 2013

Prior to the reorganization of the Finance Department which brought the Public Works Business staff into the Finance Department, bids had been done at different times for the services noted.

This year, the two bids were kept separate but were opened on the same day with the term of the contracts set so that in the future, one bid could be solicited with two items and a single award.

After review of the two bids, it is recommended that both Bid 2013-021 for Tax Bill Outsourcing and Bid 2013-022 for Water, Sewer and Storm Water Bill Outsourcing be awarded to the same vendor FISC Solutions, Lewiston, Maine, at their per unit price of \$0.1375 on tax billing and water, sewer and storm water billing.

Basis for recommendation: Estimated cost to award to one vendor.

FISC Solutions Lewiston ME	Tax Billing	.1375 X 27,500=	\$3,781.25
	Water/Sewer/StormWater	.1375 X 48,508=	6,669.85
	Total		\$10,451.10

Mailing Unltd Portland ME	Tax Billing	.1200 X 27,500=	\$3,330.00
	Water/Sewer/StormWater	.1800 X 48,508=	8,731.44
	Total		\$12,031.44

Not Recommended (separate)	Tax Billing	.1200 X 27,500=	\$3,330.00
	Water/Sewer/StormWater	.1375 X 48,508=	6,669.85
	Total		\$9,969.85

The in-house administration time in working with two separate vendors dealing with separate requirements for the billing far outweigh the variance of \$481.25 saved if awarded separately.

NJB/syt

Norman Beuparlant

From: Pamela LaBelle
Sent: Friday, May 03, 2013 8:46 AM
To: Norman Beuparlant
Subject: Tax and Utility Bill Outsourcing

After reviewing the bids I recommend that we go with FISC Solutions for both the Tax and the Utility Bill outsourcing. The bid they both put in was:

FISC Solutions	Utility Bill Outsourcing: \$0.1375/unit	Tax Bill Outsourcing: \$0.1375/unit
Mailings Unlimited	Utility Bill Outsourcing: \$0.18/unit	Tax Bill Outsourcing: \$0.12/unit

I also recommend that we go with the same vendor for both the tax bill and the utility bill processing because it would simplify the processes. Dealing with one vendor is always easier and less time consuming than dealing with two vendors.

With that said, if you calculate it out, FISC would be less expensive for the City in the end so in my opinion, FISC is the best vendor to go with.

If you have any questions or would like to talk in more detail about this don't hesitate to contact me.

Pam LaBelle

Treasury Manager/Tax Collector

City of Lewiston

27 Pine Street

Lewiston, ME 04240

207-513-3075

207-784-2959

plabelle@lewistonmaine.gov

The City of Lewiston is an EOE. For more information, please visit our website @ www.lewistonmaine.gov and click on the Non-Discrimination Policy.

 Please consider the environment before printing this email.

City of Lewiston , Maine
 Tax Bill Outsourcing
 Bid 2013-021 Bid Tabilation
 Bid Date : April 18, 2013

Company		Three (3) Year Contract		
		Year 1	Year 2	Year 3
Mailings Unlimited Portland Me.	Price/unit (no postage)	\$ 0.12	\$ 0.12	\$ 0.12
	Price/ thousand (no postage)	\$ 120.00	\$ 120.00	\$ 120.00
FISC Solutions Lewiston Me.	Price/unit (no postage)	\$ 0.1375	\$ 0.1375	\$ 0.1375
	Price/ thousand (no postage)	\$ 137.50	\$ 137.50	\$ 137.50
The Creative Companies Bangor Me.	Price/unit (no postage)	\$ 0.21	\$ 0.21	\$ 0.21
	Price/ thousand (no postage)	\$ 207.00	\$ 207.00	\$ 207.00
alternate(full color not on pre-printed Stock)	Price/unit (no postage)	\$ 0.224	\$ 0.224	\$ 0.224
	Price/ thousand (no postage)	\$ 224.00	\$ 224.00	\$ 224.00
Creative Imaging Group Scarborough Me.	Price/unit (no postage)	\$ 0.305	\$ 0.180	\$ 0.180
	Price/ thousand (no postage)	\$ 305.00	\$ 180.00	\$ 180.00

City of Lewiston , Maine
Water,Sewer & Stormwater Bill Outsourcing
Bid 2013-022 Bid Tabilation
Bid Date : April 18, 2013

Company	Price/unit (no postage)	Thre ee (β) Year Contract		
		Year 1	Year 2	Year 3
Mailings Unlimited Portland Me.	\$ 0.180	\$ 0.180	\$ 0.180	\$ 0.180
FISC Solutions Lewiston Me.	\$ 0.1375	\$ 0.1375	\$ 0.1375	\$ 0.1375
The Creative Companies Bangor Me.	\$ 0.207	\$ 0.207	\$ 0.207	\$ 0.207
alternate(full color not on pre-printed Stock) Price/unit (no postage)	\$ 0.224	\$ 0.224	\$ 0.224	\$ 0.224
Creative Imaging Group Scarborough Me.	\$ 0.228	\$ 0.191	\$ 0.191	\$ 0.191
Data Integrators, Inc. Fredericksburg VA	0.150	0.160	0.160	0.170



Finance Committee

Norman J. Beuparlant
Director of Budget/Purchasing
nbeuparlant@lewistonmaine.gov



Item # 8

to: Finance Committee
from: Norman Beuparlant, Purchasing Director
subject: Bid 2013-023 Work Zone Traffic Control (Flaggers)
date: May 6, 2013

The bid for Work Zone Traffic Control (Flaggers) is an annual bid to select the contractor who will provide work zone traffic control on an as needed basis for City projects that are done with City crews. It should be noted that projects that are bid to private contractors for City jobs carry Flaggers as a pay item.

It is recommended that Suburban Security be awarded the contract for services as needed at the hourly rate of \$14.48/hour per person.

NJB/syt



Department of Public Works

Jon Elie
Operations Manager

Date: April 24, 2013
To: Norm Beauparlant, Director of Purchasing
RE: 2013-023 Work Zone Traffic Control (Flaggers)

Norm,

I recommend that the Work Zone Traffic Control bid be awarded to Suburban Security based on lowest hourly costs and three prior years of reliable service.

Sincerely,

Jon Elie
Operations Manager

Copy to: D. Jones, M. Bates

TABULATION

BID TITLE: WORK ZONE TRAFFIC CONTROL (FLAGGERS)

BID #: 2013-023

OPEN DATE/TIME: APRIL 23, 2013 @ 2:00 P.M.

REQUESTING DEPT: PUBLIC WORKS

Description	Project Flagging Brunswick ME	Suburban Security Windham ME	Ace Security Lewiston ME
Hourly rate/flagger	\$15.00/hour	\$14.48/hour	\$15.75/hour
Flaggers certified under MDOT	Yes	Yes	Yes

Exceptions:

Ace Detective & Security:

- Overtime will be 1.5 (\$23.62) over 40 on job site
- Flaggers shall be given a ½ hour lunch break. Will be paid by City to break flaggger and deducted from flagger on site.